

# Warning / Alerts / Annunciations

**Level 0 – Cyan alert**  
 (no Mstr Caution or Mstr Wrng light)  
**General Status Message**

**Takeoff Essential Items Checklist** – Alerts if stabilizer, flaps, slats, spoilers or brakes are not in proper configuration for takeoff. Empty green box  indicates takeoff conditions are satisfied

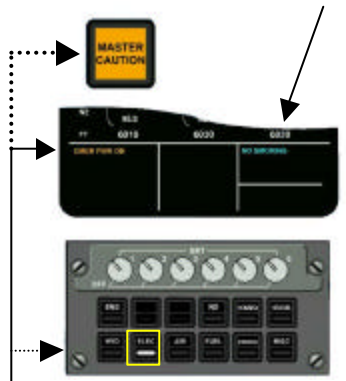

**Level 1 – Amber alert**  
 May also illuminate Mstr Caution light and SD Cue  
 May require maintenance, logbook entry or confirmation of system configuration

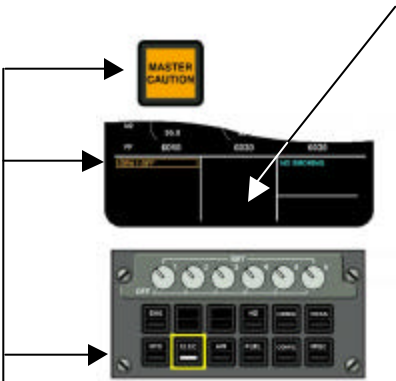

**Level 2 – Boxed Amber alert**  
 Illuminates Mstr Caution light and SDCP Cue  
**Immediate Crew Awareness and possible subsequent crew action Required**

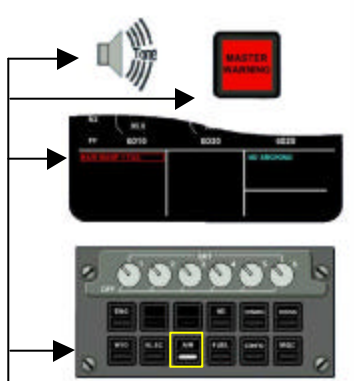

**Level 3 – Boxed Red alert**  
 Illuminates Mstr Warning light and SD Cue, and sounds Attn Tone  
**Immediate Crew Awareness and Immediate Crew Action Required**